

▲ HARDWARE SUPPLIED
DN SWITCH

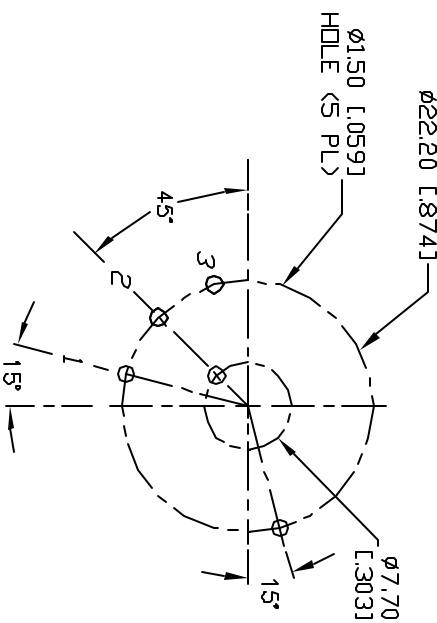
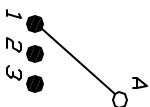

- NOTES:
1. ALL DIMENSION IN MM [INCH]
 2. GENERAL TOLERANCE: X.XX=±0.4 X:XX=±0.25
 3. TERM. NOS. FOR REF. ONLY
 4. CONTACT RATING SWITCHING: 150mA, 250V AC/DC
 5. CONTACT MATERIAL: COPPER ALLOW W/SILVER PLATING
 6. OPERATING FORCE: 425±100 CM/STANDARD
 7. OPERATING TEMP: -30° to 85°C
 8. CIRCUIT SP: 3 POSITIONS, 30° INDEX.
 9. DIELECTRIC STRENGTH: 1000V RMS min. @ SEA LEVEL
 10. ▲ DENOTES CRITICAL PARAMETER
 11. HARDWARE SUPPLIED ON SWITCH - SEE BELOW STOP RING, LOCKWASHER, & HEXNUT

A	13282	RELEASED FOR PRODUCTION	7/11/03	AR
REV.	ECN No.	DESCRIPTION	DATE	CHKD

TITLE	SCALE	DATE	DR	DWG	REV
KC13A38.001NPS	1.5:1	7/11/03	AR	G527531	A

THE INFORMATION CONTAINED IN THIS DOCUMENT IS PROPRIETARY TO E-SWITCH AND IS NOT TO BE COPIED OR TRANSFERRED

E-SWITCH®