

- BGA adapter/socket systems are a reliable way to make BGAs pluggable, they may also be used as a high density board-to-board interconnect.
- The BGA device is soldered to a 8737/4048 adapter (or a 4098/4054 adapter is soldered to a PCB); and then either one can be plugged into a 8214 surface mount socket.
- Both socket and adapter have the same footprint as the BGA device.
- Insertion force is .40N per pin for standard pins 8737/4098. Tapered EZ-IN pins 4048/4054 reduce insertion force to only .08N, and are recommended for pin counts greater than 500. A pry-bar tool (part #828-01-010) is available for extraction.
- Insulator material is FR-4 epoxy having a TCE to match the BGA device and circuit board.
- Mill-Max offers the option of having the solder surfaces of the 4098/4054 adapters and 8214 socket pre-tinned.

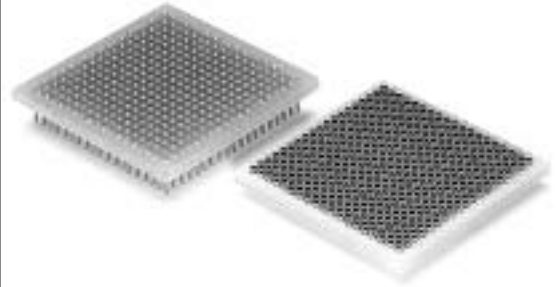

BGA MOUNT ADAPTER PINS

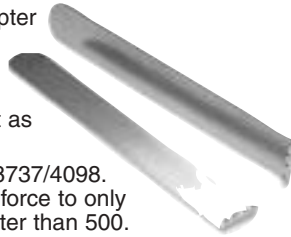
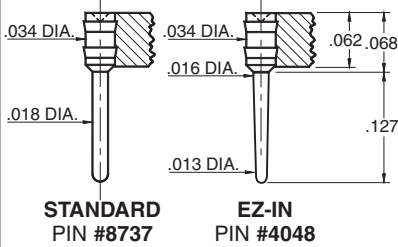

PCB MOUNT STANDARD ADAPTER PIN #4098

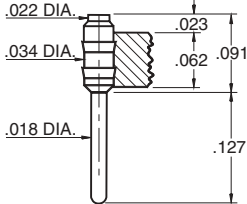

PCB MOUNT EZ-IN ADAPTER PIN #4054

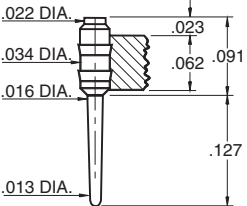

SMT RECEPTACLE TYPE #8214

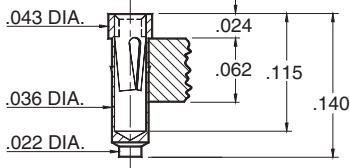

Ordering Information

FOR BGA MOUNT ADAPTER PINS

Series	Plating Code	Window	
5 8 7	1 0	[] [] [] - [] [] - [] [] []	4 3 7 STANDARD
5 4 0	1 0	[] [] [] - [] [] - [] [] []	4 4 8 EZ-IN PIN

FOR PCB MOUNT STANDARD ADAPTER PIN

5 4 0	1 0	[] [] [] - [] [] - [] [] []	4 9 8
5 9 7	1 0	[] [] [] - [] [] - [] [] []	4 1 6 PRE-TINNED

FOR PCB MOUNT EZ-IN ADAPTER PIN

5 4 0	1 0	[] [] [] - [] [] - [] [] []	4 5 4
5 9 7	1 0	[] [] [] - [] [] - [] [] []	4 3 0 PRE-TINNED

No. of pins Grid size Pattern #

Determined from footprint pattern pages 113 to 115

PLATING CODE XX=	10			
Pin Plating	10μ" Au			

FOR BGA FEMALE SOCKET

Series	Plating Code	Window	
5 8 2	1 1	[] [] [] - [] [] - [] [] []	4 1 4
5 9 5	1 1	[] [] [] - [] [] - [] [] []	4 2 6 PRE-TINNED

No. of pins Grid size Pattern #

Determined from footprint pattern pages 113 to 115

SPECIFY PLATING CODE XX=	11			
Sleeve (Pin)	10μ" Au			
Contact (Clip)	10μ" Au			