

**MARKETING SALES DRAWING**

**DIMENSIONS IN INCHES - DO NOT SCALE THIS DRAWING**  
**DIMENSIONS IN METRIC - [ ]**

This drawing is the property of Tusonix, Inc., and may not be used, reproduced, published or disclosed to others without expressed authorization by Tusonix Inc.

**Electrical Testing**  
**per Tusonix standard**  
**test plans and Mil-Std-202**  
**Test Methods.**

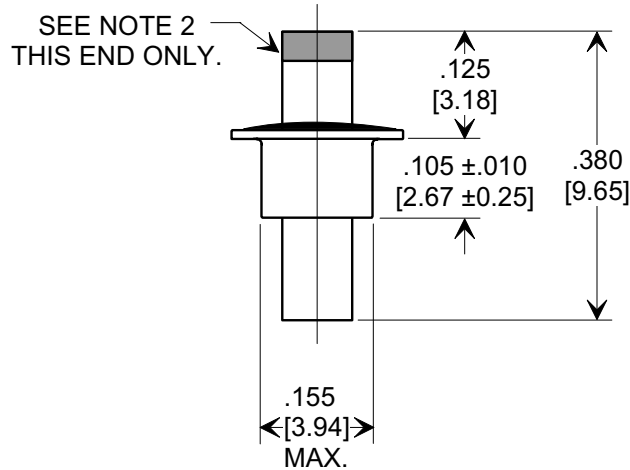
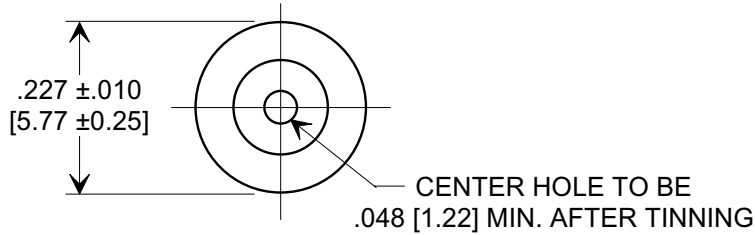
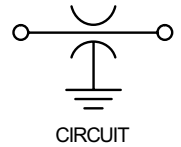
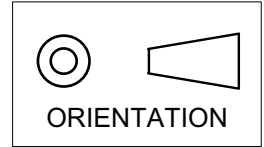

**NOTES:**

- TUSONIX STANDARD PART NUMBER: 2404-620-X5U0-102P.  
TUSONIX RoHS COMPLIANT PART NUMBER: 2404-620-X5U0-102P LF.  
CUSTOMER MUST SPECIFY STANDARD OR RoHS PART NUMBER WHEN ORDERING.
- CONTACT END: STANDARD PART #: 60/40 SOLDER OVER SILVER ELECTRODE. RoHS PART #: FIRED ON SILVER ELECTRODE ONLY.
- EYELET FINISH: STANDARD PART #:60/40 SOLDER PLATED. RoHS PART #: SILVER PLATED.
- PART MARKING: STANDARD PART: 3 DOT COLOR CODE. RoHS PART: ADDITIONAL GREEN DOT IDENTIFIER.

**SPECIFICATIONS**

TUSONIX STYLE:	2404-620
CAPACITANCE:	1000 pF
TOLERANCE:	+100% -0%
TEMP. COEF.:	X5U
OPERATING TEMP.:	-55°C TO 125°C
VOLTAGE RATING:	500 VDC @ + 85°C
DWV:	875 VDC
IR MIN. @ 100 VDC:	10 GΩ

<b>REVISION RECORD</b>	Original Release	<b>0</b>
	C.O. 20060214-2-01	
	DIM. .155 WAS .160. REVISED NOTE 2. S.M. 05-11-06	
	20060510-3-02	<b>1</b>
CORRECTED NOTE NUMBER. WAS 3. EC05-31-06		
20060531-3-02	<b>2</b>	

--TOLERANCES-- Unless Otherwise Specified		Title <b>FEED - THRU CAPACITOR</b>	
DECIMAL ± .015 [0.38]		Drawn S.M. 02-16-06	Scale 4 X
ANGLES ±		Approved R.C. 02-16-06	
<b>TUSONIX</b> TUCSON, ARIZONA		<b>A 2404-620-X5U0-102P</b>	