



TAI-SAW TECHNOLOGY CO., LTD.

No. 3, Industrial 2nd Rd., Ping-Chen Industrial District,
Taoyuan, 324, Taiwan, R.O.C.

TEL: 886-3-4690038 FAX: 886-3-4697532

E-mail: tstsales@mail.taisaw.com Web: www.taisaw.com

Product Specifications Approval Sheet

Product Description: SAW Filter 2375MHz SMD 3.0X3.0 mm(BW=100MHz)

TST Part No.: TA1073A

Customer Part No.: _____

| |
|-----------------------------|
| Customer signature required |
| Company: _____ |
| Division: _____ |
| Approved by : _____ |
| Date: _____ |

Checked by: Paul Ni *Paul Ni*

Approved by: Francis Chen *Francis Chen*

Date: 2009/11/05

1. Customer signed back is required before TST can proceed with sample build and receive orders.
2. Orders received without customer signed back will be regarded as agreement on the specifications.
3. Any specifications changes must be approved upon by both parties and a new revision of specifications shall be released to reflect the changes.



TAI-SAW TECHNOLOGY CO., LTD.

No. 3, Industrial 2nd Rd., Ping-Chen Industrial District,
Taoyuan, 324, Taiwan, R.O.C.

TEL: 886-3-4690038 FAX: 886-3-4697532

E-mail: tstsales@mail.taisaw.com Web: www.taisaw.com

SAW Filter 2375MHz
MODEL NO.: TA1073A

REV. NO : 2.0

A. MAXIMUM RATING:

1. Input Power Level: 10 dB_m
2. DC voltage: 3 V
3. Operating Temperature: 0°C to +80°C
4. Storage Temperature: -40°C to +85°C

RoHS Compliant
Lead free
Lead-free soldering

B. ELECTRICAL CHARACTERISTICS:

| Item | | Min. | Typ. | Max. |
|--|---------------------------------|------|------|------|
| Center frequency | F_c MHz | - | 2375 | - |
| Insertion loss (2360 ~ 2390MHz) | IL dB | - | 1.8 | 2.5 |
| Insertion loss (2310 ~ 2360MHz) | IL dB | - | 2.8 | 4.5 |
| Insertion loss (2300 ~ 2310MHz) | IL dB | - | 4.8 | 6.0 |
| Insertion loss (2390 ~ 2400MHz) | IL dB | - | 2.8 | 4.5 |
| Amplitude ripple (2360~2390 MHz) | dB | - | 0.6 | 1.0 |
| Amplitude ripple (2310~2360 MHz) | dB | - | 1.1 | 1.5 |
| Amplitude ripple (2300~2310 MHz) | dB | - | 1.7 | 2.5 |
| Amplitude ripple (2390~2400 MHz) | dB | - | 1.1 | 2.0 |
| VSWR (2300~2400 MHz) | | | 1.85 | 2.5 |
| Attenuation (Reference level from 0 dB) | | | | |
| D.C. ~ 2200 MHz | dB | 23 | 29.5 | - |
| 2452 ~ 2472 MHz | dB | 45 | 62 | - |
| 2472 ~ 4000 MHz | dB | 30 | 35 | - |
| Temperature Coefficient | Ppm/°C | - | -36 | - |
| Source impedance | Z_s Ω | - | 50 | - |
| Load impedance | Z_L Ω | - | 50 | - |

C. MEASUREMENT CIRCUIT:

50 Ohm Test circuit (single-ended / single-ended)

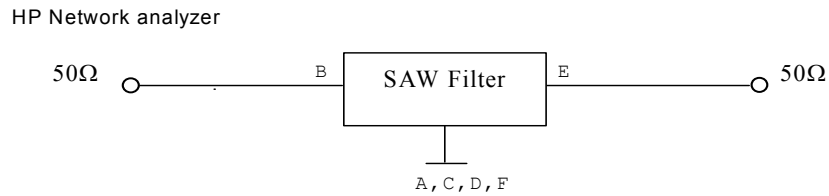

D.OUTLINE DRAWING:

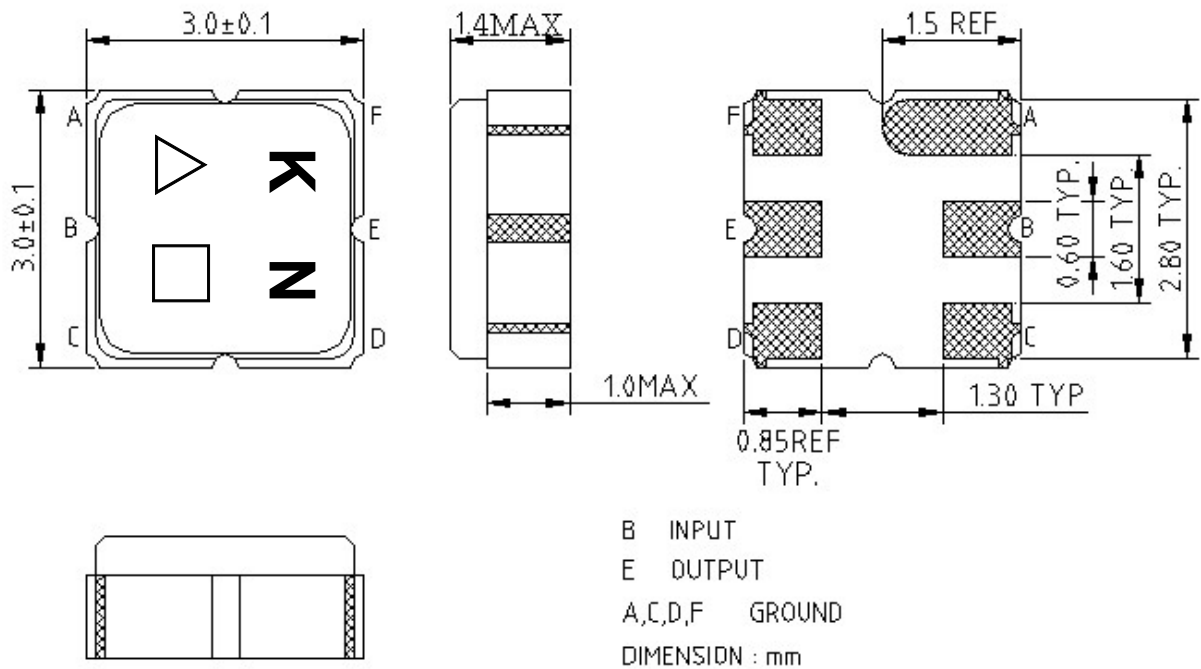

△ : Year Code(2009→9,2010→0...2019→9)

□ : Date Code(Follow the table from planner each year)

E. PCB Footprint :

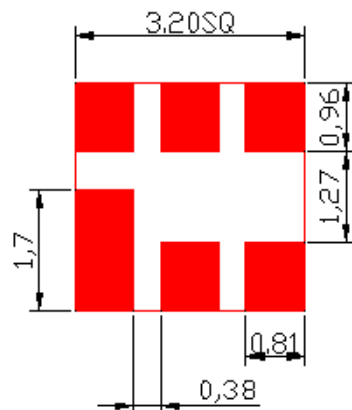

F. Frequency Characteristics : Transfer function

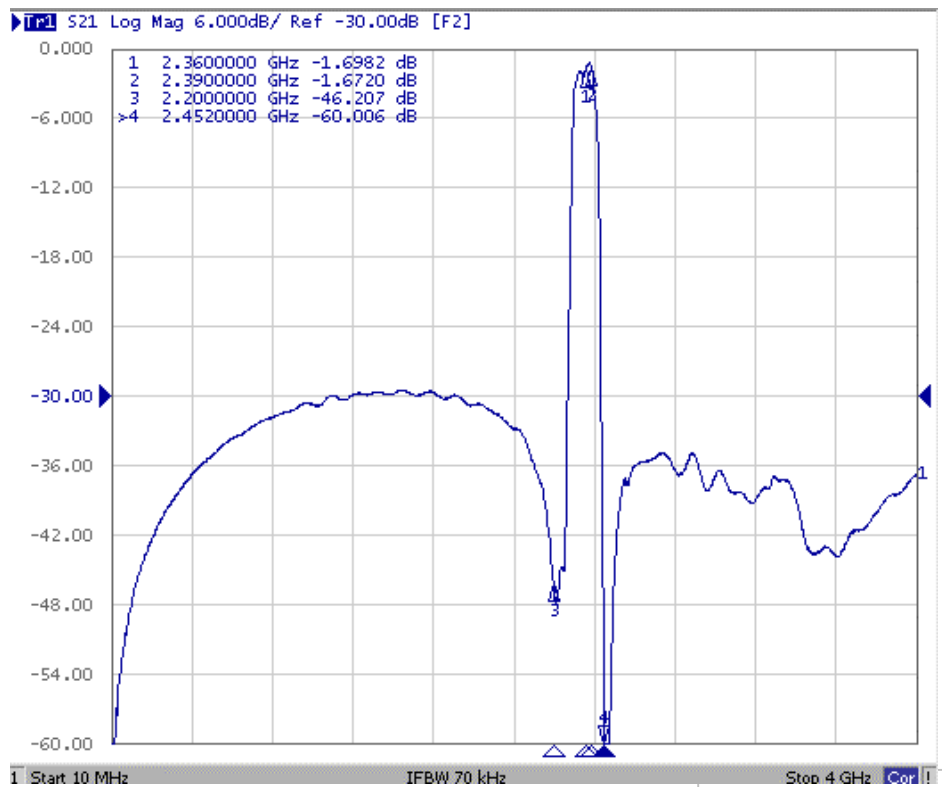
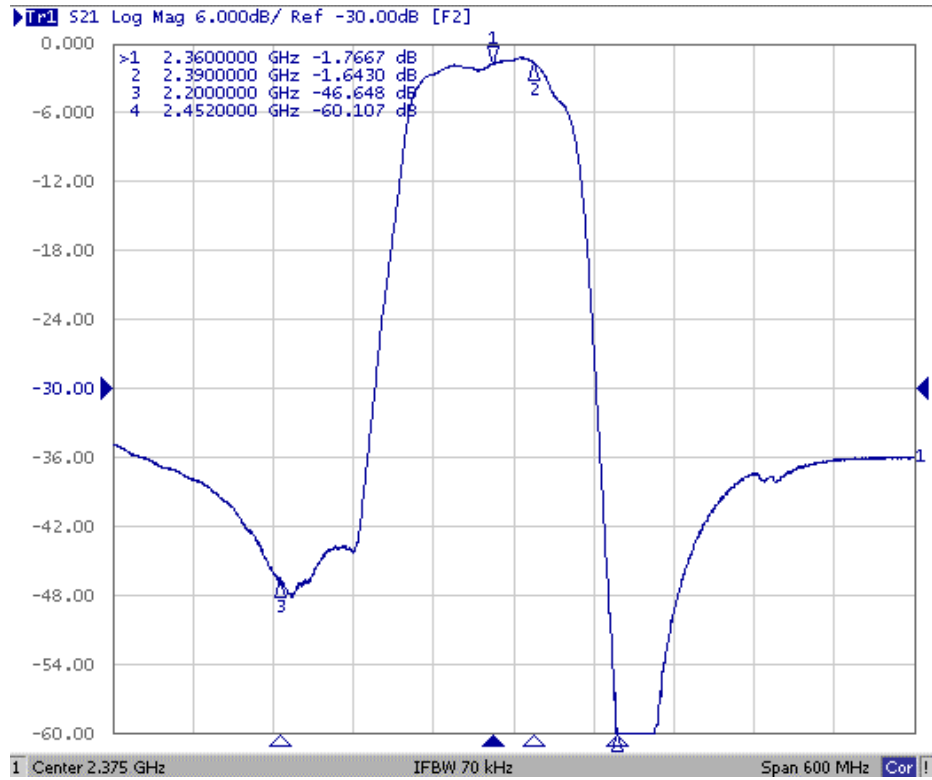

Reflection Functions :

S11

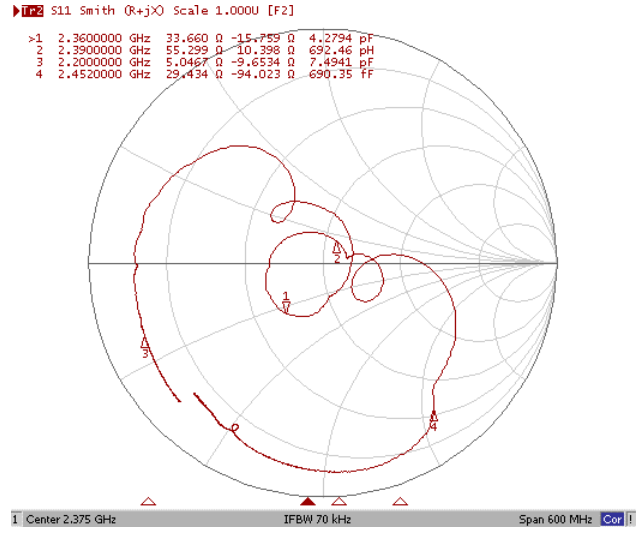
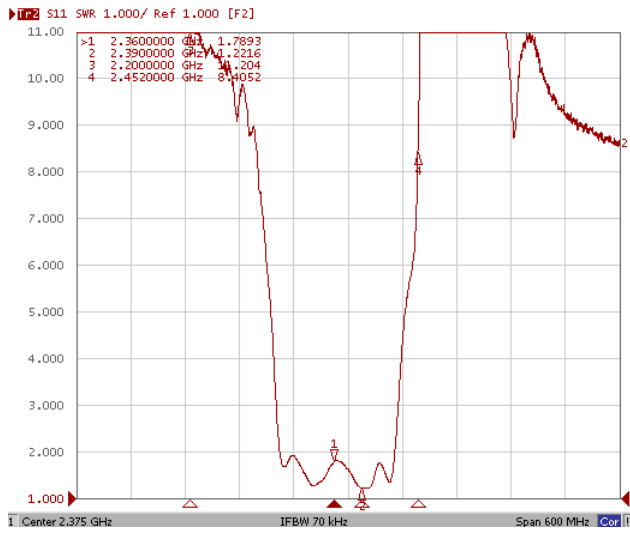

S22

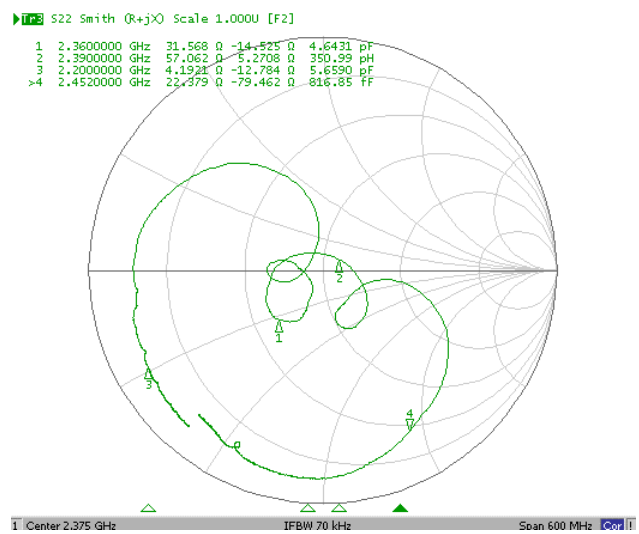
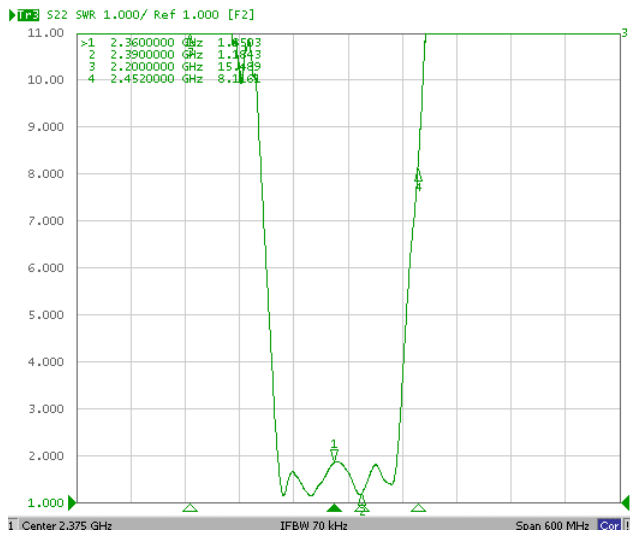

G. PACKING:

1. REEL DIMENSION

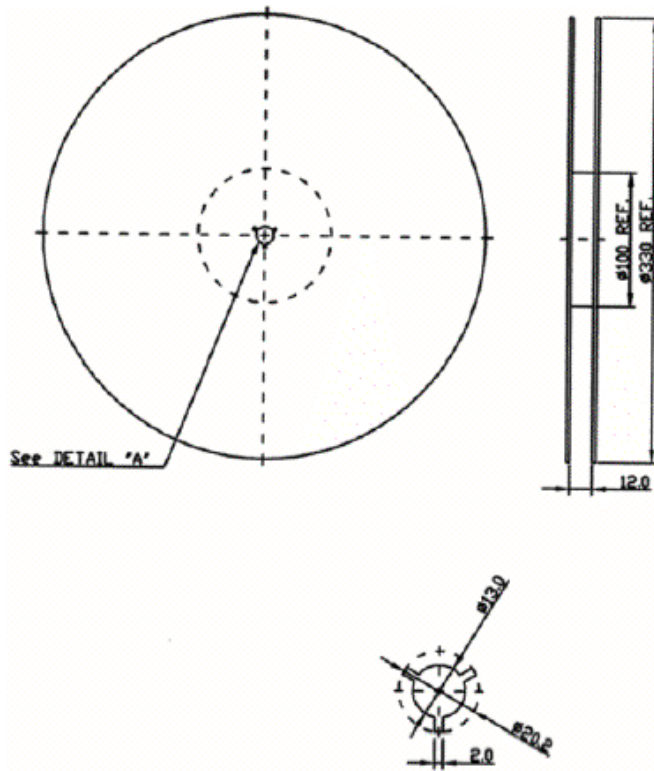

2. TAPE DIMENSION

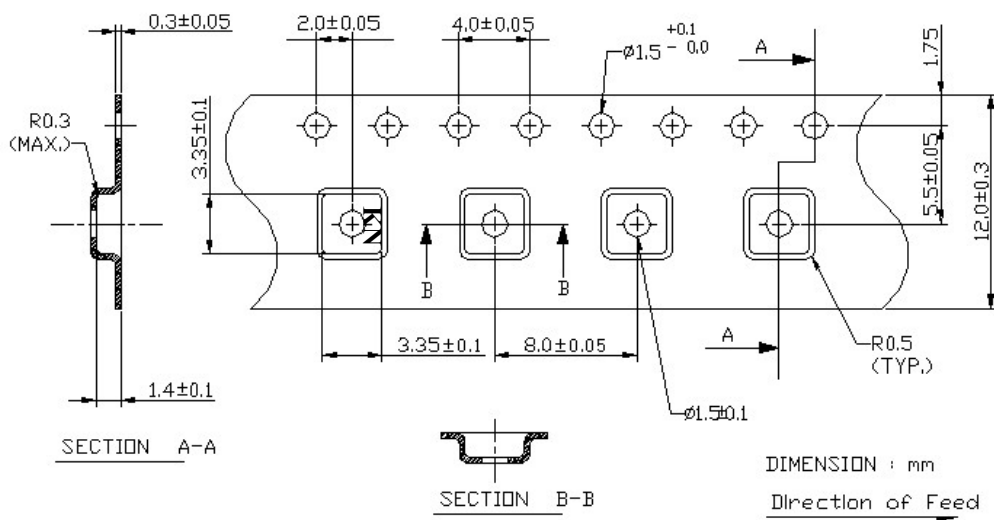

H. RECOMMENDED REFLOW PROFILE:

