



# TAI-SAW TECHNOLOGY CO., LTD.

No. 3, Industrial 2nd Rd., Ping-Chen Industrial District,  
Taoyuan, 324, Taiwan, R.O.C.

TEL: 886-3-4690038 FAX: 886-3-4697532

E-mail: [tstsales@mail.taisaw.com](mailto:tstsales@mail.taisaw.com) Web: [www.taisaw.com](http://www.taisaw.com)

## Approval Sheet For Product Specification

Issued Date:

Product Name: SAW Filter 460MHz SMD 5.0x5.0mm

TST Parts No.:TA0731A

Customer Parts No.:\_\_\_\_\_

Company: _____
Division: _____
Approved by : _____
Date: _____

Checked by: \_\_\_\_\_ Andy Yu

Approval by: \_\_\_\_\_ Francis Chen

Date: \_\_\_\_\_ 2007/9/28



# TAI-SAW TECHNOLOGY CO., LTD.

No. 3, Industrial 2nd Rd., Ping-Chen Industrial District,  
Taoyuan, 324, Taiwan, R.O.C.

TEL: 886-3-4690038 FAX: 886-3-4697532

E-mail: [tstsales@mail.taisaw.com](mailto:tstsales@mail.taisaw.com) Web: [www.taisaw.com](http://www.taisaw.com)

## SAW Filter 460 MHz

MODEL NO.: TA0731A

REV. NO.:1

### A. MAXIMUM RATING:

1. Input Power Level: 26 dB<sub>m</sub>
2. DC voltage: 3 V
3. Operating Temperature: -50°C to +85°C
4. Storage Temperature: -50°C to +85°C

RoHS Compliant  
Lead free  
Lead-free soldering

### B. ELECTRICAL CHARACTERISTICS:

Item	Unit	Min.	Type.	Max.	
Center frequency F <sub>c</sub>	MHz	-	460	-	
Insertion Loss IL <sub>min</sub> (reference level)	dB	-	1.8	3.0	
1dB Bandwidth BW <sub>-1dB</sub>	MHz	-	21.6	-	
3dB Bandwidth BW <sub>-3dB</sub>	MHz	20	24.5	-	
Absolute Attenuation:(Reference level from 0dB)					
F <sub>c</sub> -40.8 to F <sub>c</sub> -100	MHz	dB	42	57	-
F <sub>c</sub> +40 to F <sub>c</sub> +100	MHz	dB	40	46	-
Source impedance Z <sub>s</sub>	Ω	-	50	-	
Load impedance Z <sub>L</sub>	Ω	-	50	-	

Note: IL<sub>min</sub> is the minimum of the pass band attenuation. The center frequency F<sub>c</sub> is the mean value of the upper and lower frequencies at the 3dB filter attenuation level relative to the IL<sub>min</sub>.

### C. Frequency Characteristics :

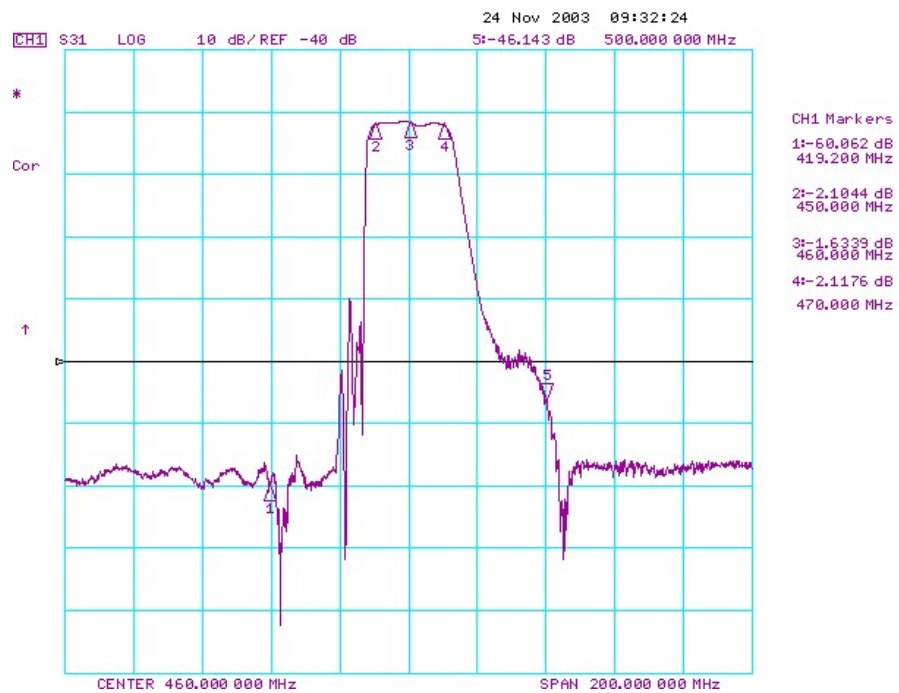

**D. MEASUREMENT CIRCUIT:**

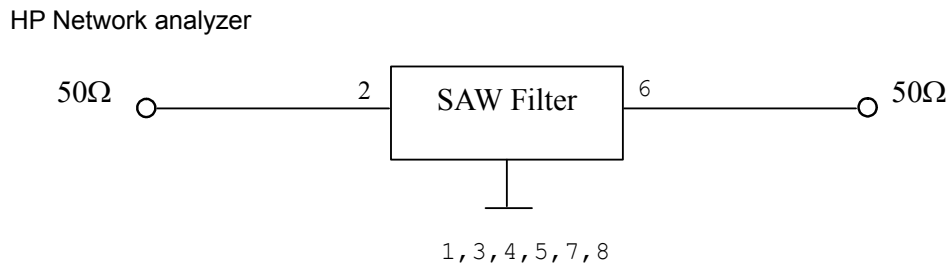

**E. OUTLINE DRAWING:**

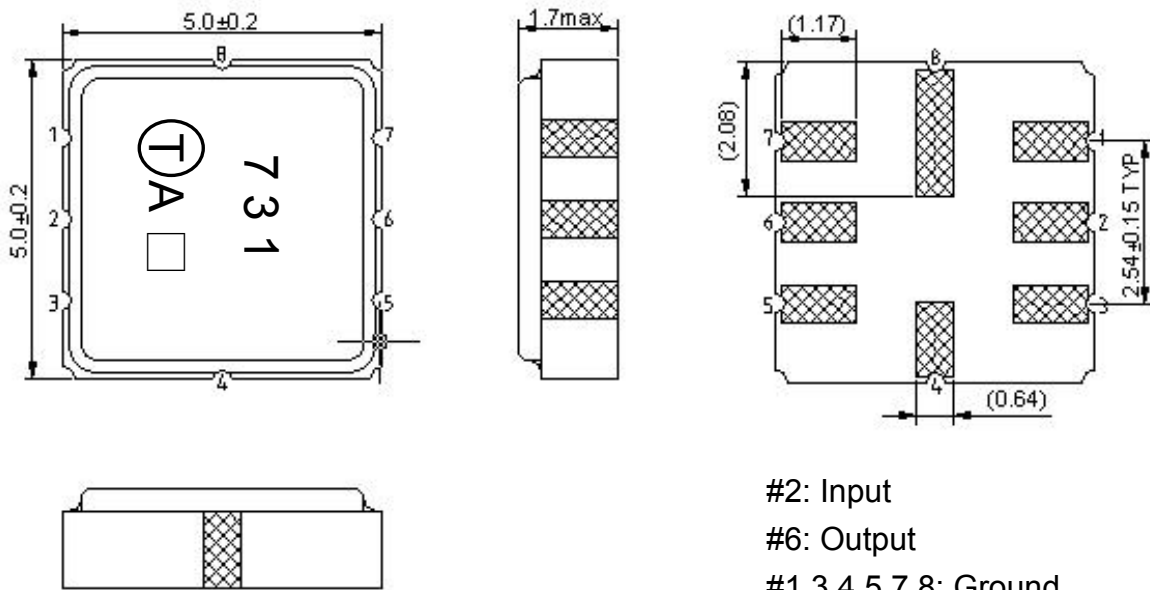

#2: Input  
 #6: Output  
 #1,3,4,5,7,8: Ground  
 □ : Date Code  
 Unit: mm

## F. PACKING:

### 1. REEL DIMENSION

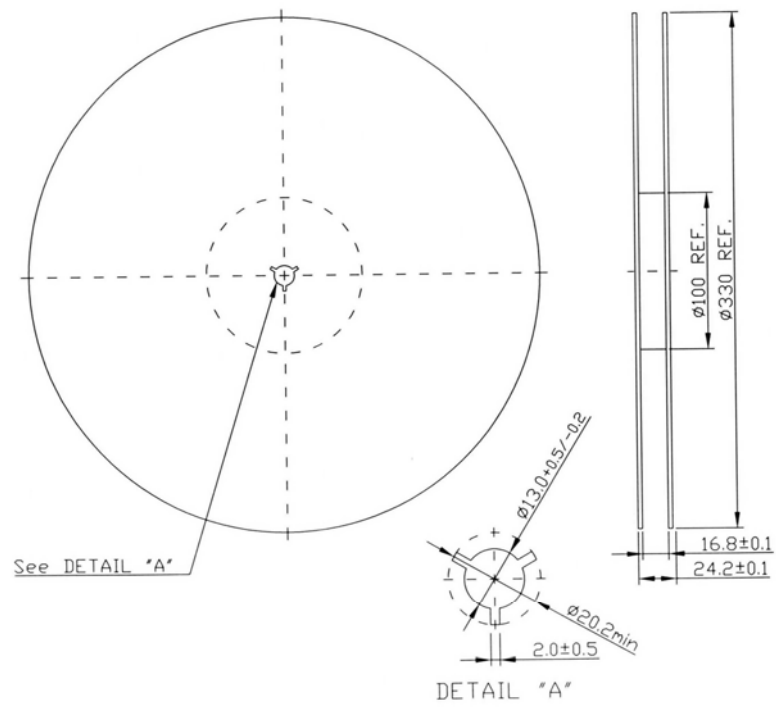

### 2. TAPE DIMENSION

